

INSTALLATION OF LEAFLAT PRODUCT ON FINISHED WOOD SURFACES

- PROCESS OF PREPARING THE WOOD SURFACE

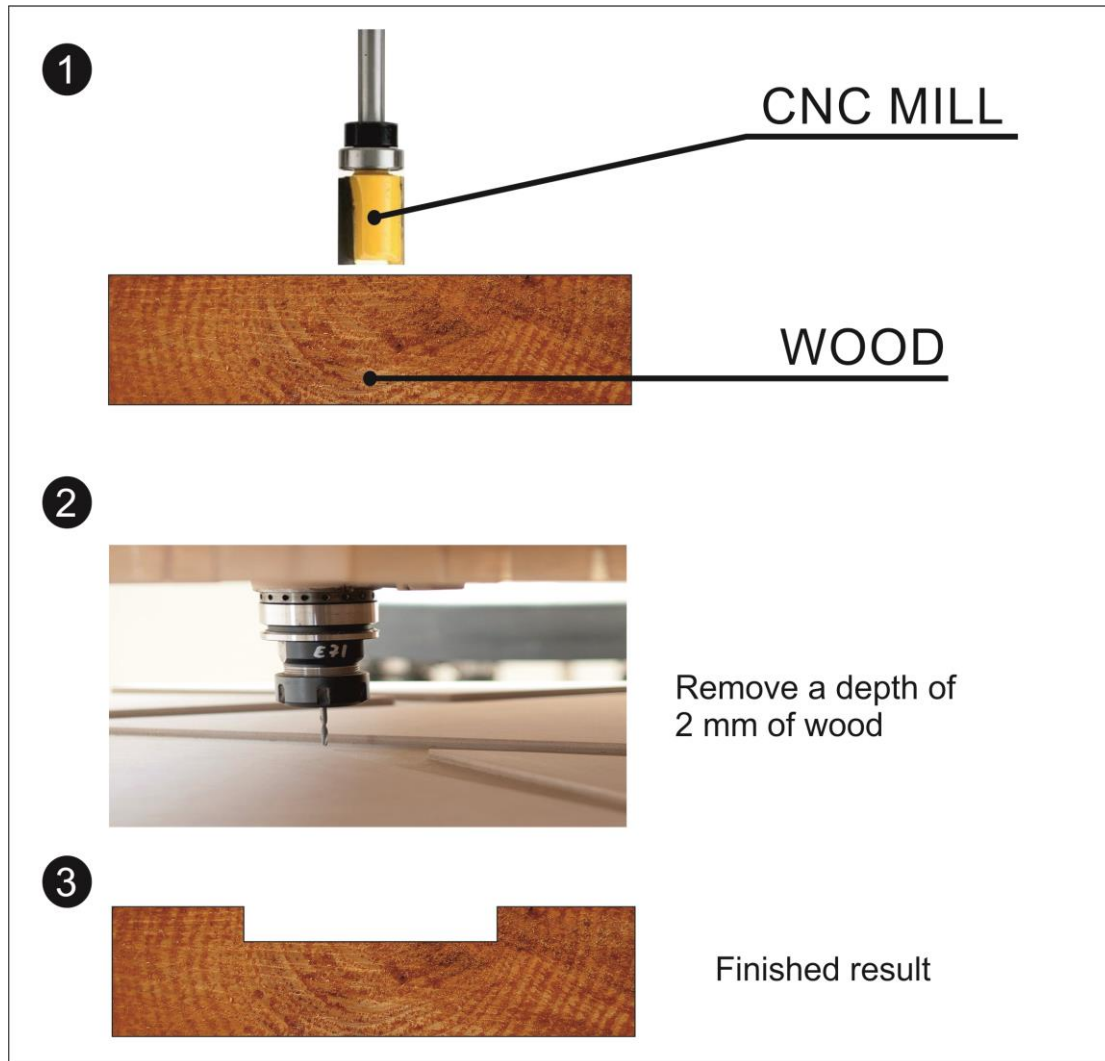

Through CNC milling, approximately 2mm of material needs to be removed from the wood surface.

We always recommend assessing the final thickness of the requested Leaf flat product before removing any wood.

Each type of processing may require different thicknesses.

- INSTALLATION PROCESS

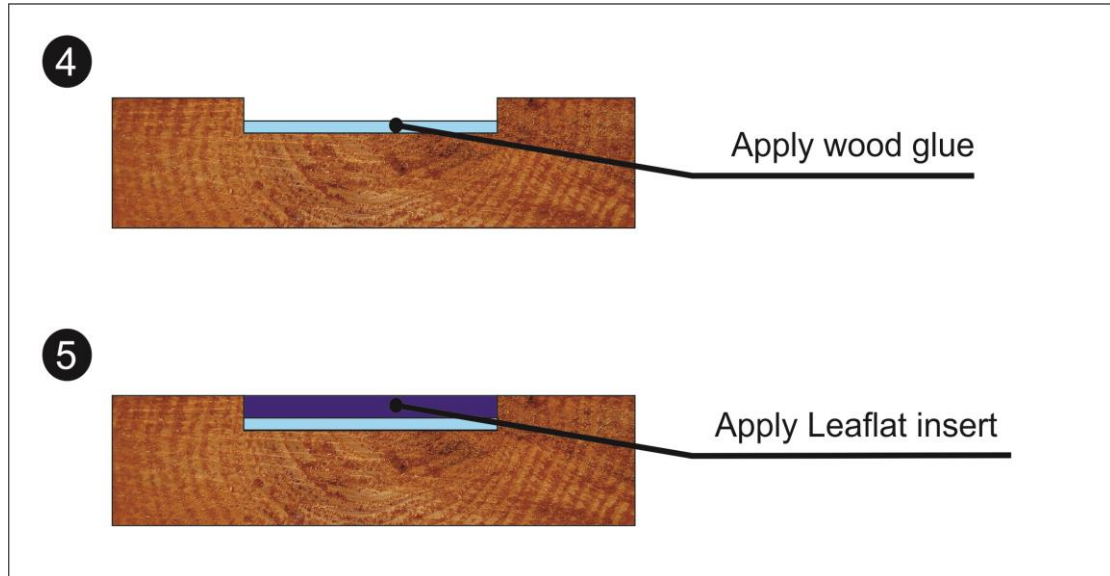

After checking that the Leaflat product fits correctly into the wooden base,
we proceed by applying wood adhesive to the base of the slot (4),
and then we insert and position the Leaflat product (5).

**WAIT FOR THE ADHESIVE TO DRY AS REPORTED ON THE TECHNICAL
DATA SHEET.**

INSTALLATION OF LEAFLAT PRODUCT ON RAW WOOD SURFACES

- PROCESS OF PREPARING THE WOOD SURFACE

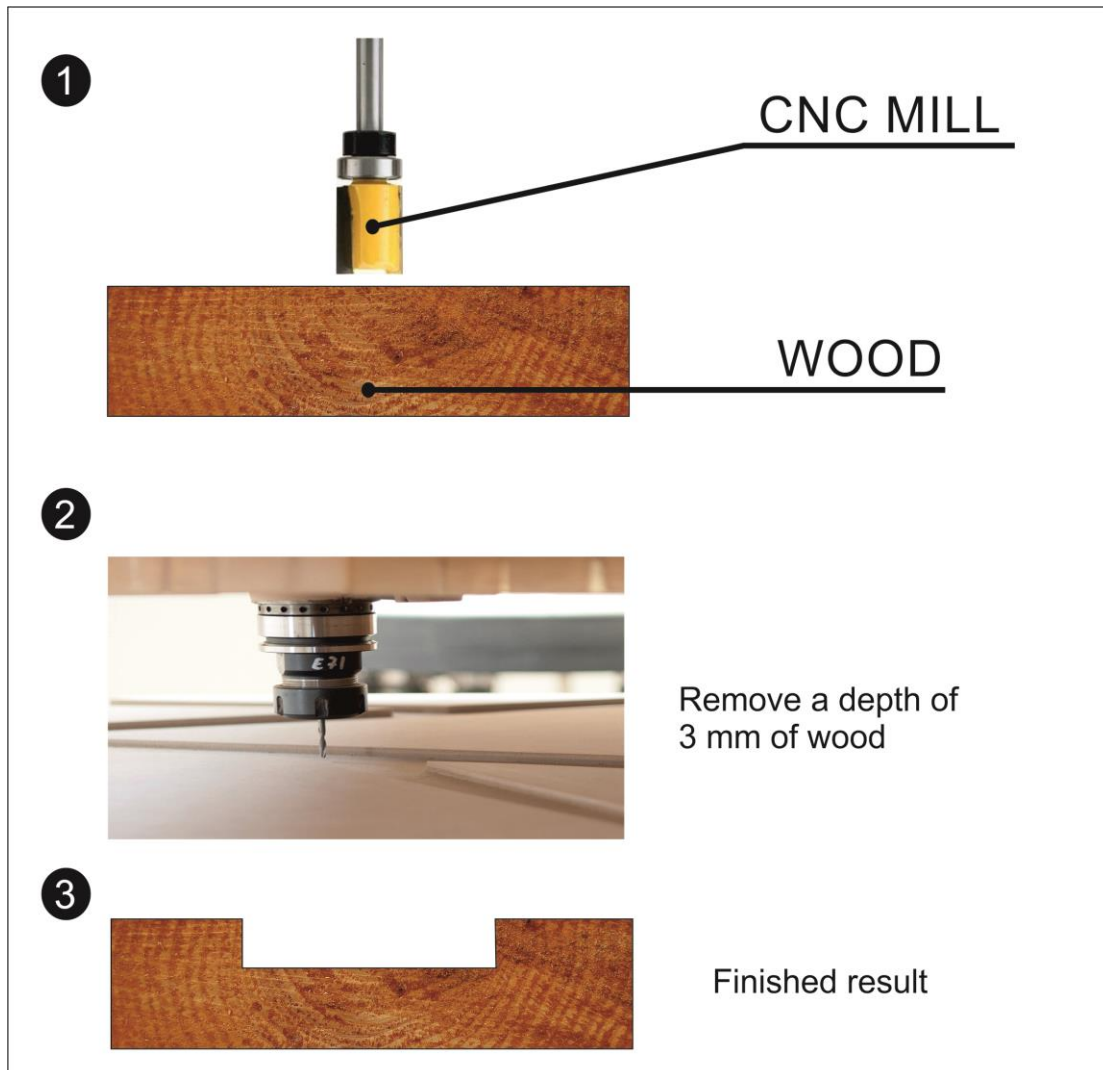

Through CNC milling, approximately 3 mm of material needs to be removed from the wood surface.

We always recommend assessing the final thickness of the requested Leaf flat product before removing any wood.

Each type of processing may require different thicknesses.

- INSTALLATION PROCESS

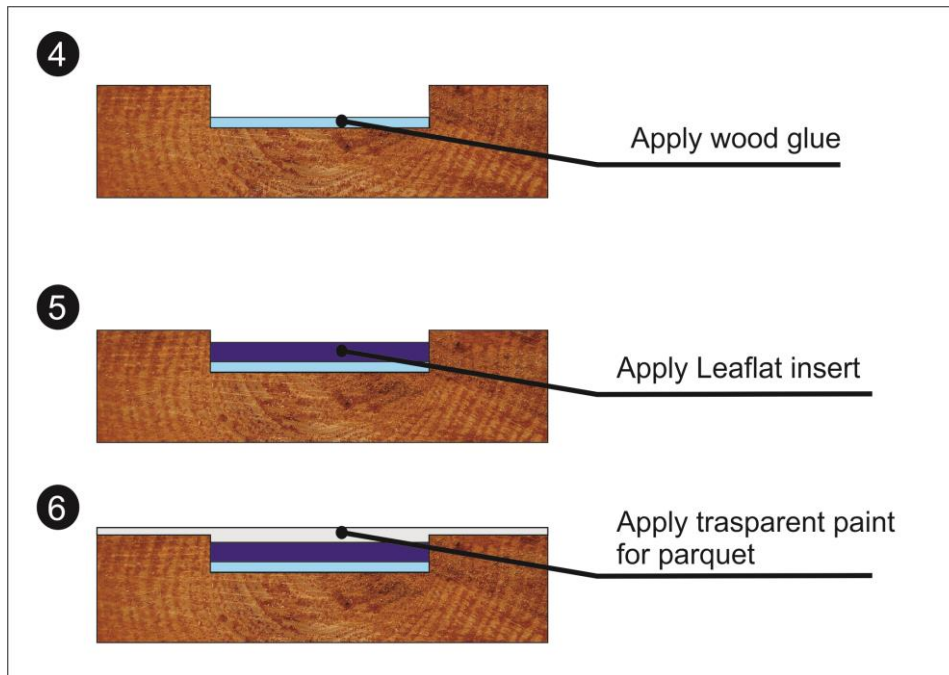

After checking that the Leaflat product fits correctly into the wooden base, we proceed by applying wood adhesive to the base of the slot (4), and then we insert and position the Leaflat product (5).

WAIT FOR THE ADHESIVE TO DRY AS REPORTED ON THE TECHNICAL DATA SHEET.

Once the drying process is complete, we can matte the surfaces and proceed with the installation of the protective paint for parquet or furniture on both surfaces.